

MODEL	SHELL VOLUME [litres]	TUBES VOLUME [litres]	EXCHANGE AREA [m ²]	SHELL SECTION [mm ²]	TUBES SECTION [mm ²]	WEIGHT [kg]
MLI 219 1000	17.40	13.94	3.44	16502.5	15522.6	67.0
MLI 219 1500	25.65	21.70	5.36	16502.5	15522.6	89.3
MLI 219 2000	33.90	29.46	7.27	16502.5	15522.6	111.5
MLI 219 3000	50.40	44.98	11.11	16502.5	15522.6	155.9
MLI 219 6000	99.91	91.55	22.61	16502.5	15522.6	289.1

Category calculation for second group's fluids - Gas, melted gas and liquids with a steam tension at maximum temperature > 0.5 bar

Article 4.3
1st Category
2nd Category
3rd Category

MODEL	VOLUME [litres]	PRESSURE [bar] *											
		1	2	3	4	5	6	7	8	9	10	11	12
MLI 219 1000	Shell / Tubes		2.8	3.5								11.4	
MLI 219 1500	Shell / Tubes	1.9	2.3					7.7		9.2			
MLI 219 2000	Shell / Tubes	1.4	1.6			5.8	6.7						
MLI 219 3000	Shell / Tubes		1.1	3.9	4.4								
MLI 219 6000	Shell / Tubes		2.0	2.1							10.0	10.9	

* for higher pressure contact MBS

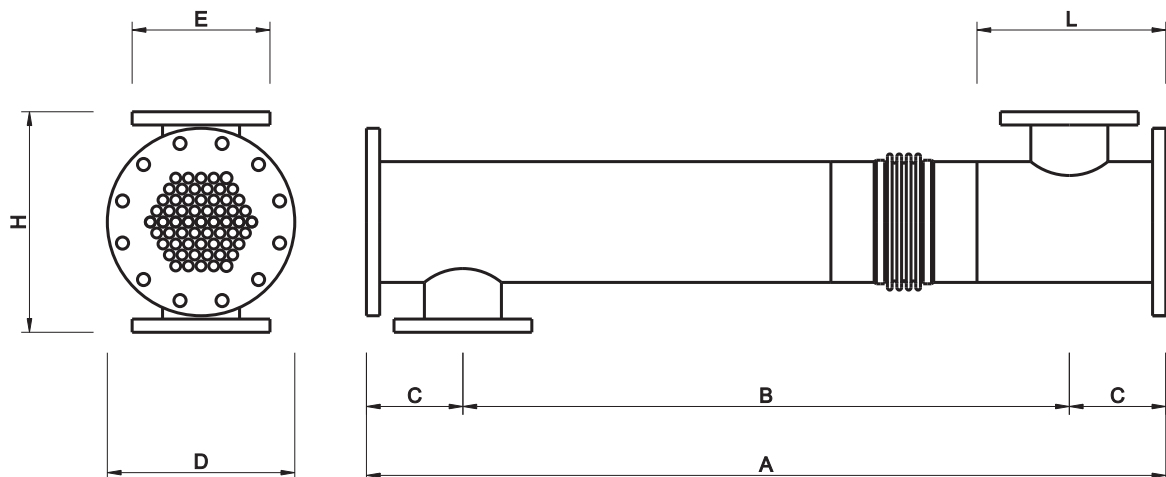

MODEL	DIMENSIONS [mm]						
	A	B	C	D	E	H	L
MLI 219 1000	950	600	175	EN 1092-1 DN 200 PN.16	EN 1092-1 DN 125 PN.16	400	342.5
MLI 219 1500	1450	1100					
MLI 219 2000	1950	1600					
MLI 219 3000	2950	2600					
MLI 219 6000	5950	5600					

Not binding technical datas; may be modified by the Manufactures without advise